

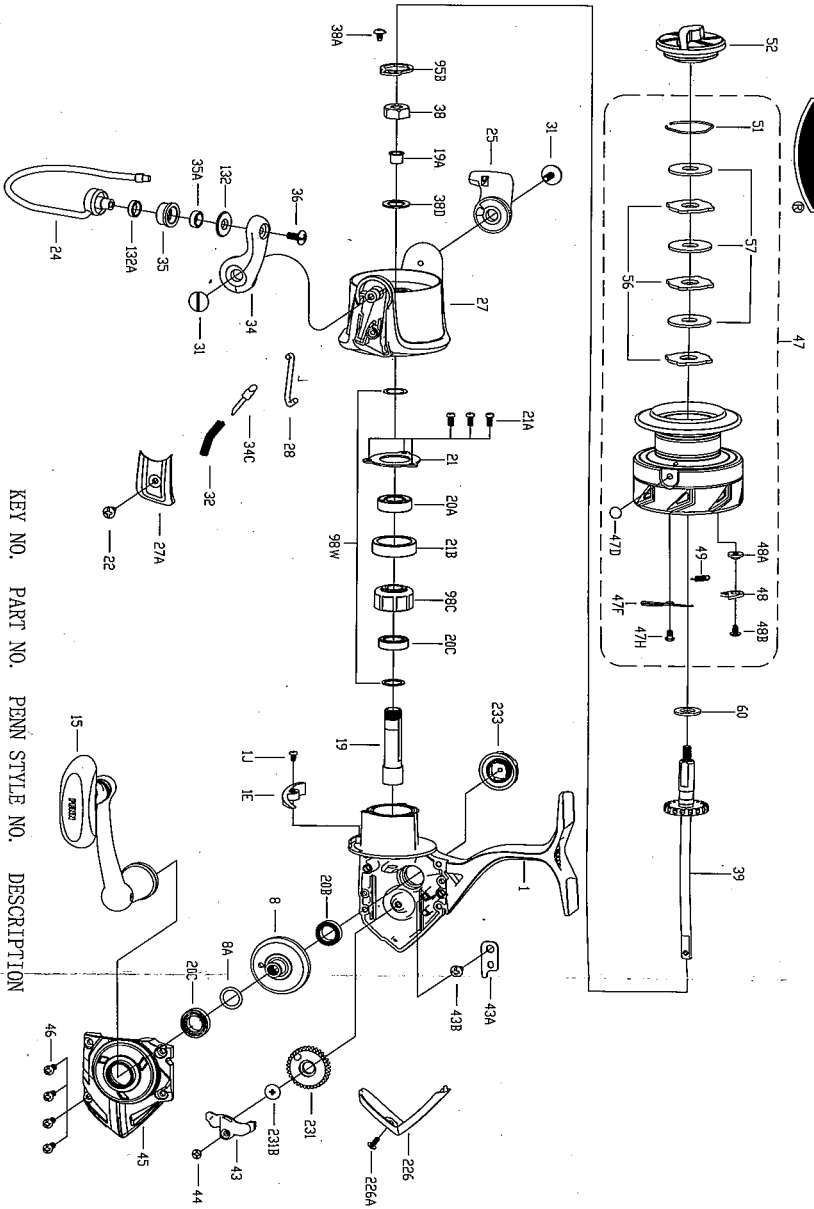

PARTS LIST FOR MODEL BTL1113000



407-BTL1113000 Rev. 0 8-30-2019  
1518032

KEY NO.	PART NO.	PENN STYLE NO.	DESCRIPTION	KEY NO.	PART NO.	PENN STYLE NO.	DESCRIPTION
25	1529185	25-BTL1113000	Bail Holder	25	1529185	25-BTL1113000	Bail Holder
27	1529186	27-BTL1113000	Rotor	27	1529186	27-BTL1113000	Rotor
27A	1529187	27A-BTL1113000	Bail Pivot Cover	27A	1529187	27A-BTL1113000	Bail Pivot Cover
28	1529188	28-BTL1113000	Trip Lever	28	1529188	28-BTL1113000	Trip Lever
31	1308063	31-CFT3000	Bail Arm Screw (2 req)	31	1308063	31-CFT3000	Bail Arm Screw (2 req)
32	1191586	32-3000SG	Bail Spring	32	1191586	32-3000SG	Bail Spring
34	1308064	34-CFT3000	Bail Arm	34	1308064	34-CFT3000	Bail Arm
34C	1489198	34C-SSVT3500	Pivot Arm	34C	1489198	34C-SSVT3500	Pivot Arm
35	1489199	35-SSVT3500	Line Roller	35	1489199	35-SSVT3500	Line Roller
35A	1489200	35A-SSVT3500	Roller Bearing	35A	1489200	35A-SSVT3500	Roller Bearing
36	1191699	36-3000SG	Bail Stud Screw	36	1191699	36-3000SG	Bail Stud Screw
38	1191728	38-3000SG	Rotor Nut	38	1191728	38-3000SG	Rotor Nut
38A	1308069	38A-CFT3000	Rotor Locking Plate Screw	38A	1308069	38A-CFT3000	Rotor Locking Plate Screw
38D	1308070	38D-CFT3000	Rotor Nut Washer	38D	1308070	38D-CFT3000	Rotor Nut Washer
39	1529379	39-BTL1113000	Main Shaft Assembly	39	1529379	39-BTL1113000	Main Shaft Assembly
43	1485219	43-PUR1113000	Crosswind Block	43	1485219	43-PUR1113000	Crosswind Block
43A	1191818	43A-3000SG	Crosswind Block Plate	43A	1191818	43A-3000SG	Crosswind Block Plate
43B	1489213	43B-SSVT3500	Crosswind Block Plate Screw	43B	1489213	43B-SSVT3500	Crosswind Block Plate Screw
44	1191843	44-3000SG	Crosswind Block Screw	44	1191843	44-3000SG	Crosswind Block Screw
45	1529380	45-BTL1113000	Housing Cover	45	1529380	45-BTL1113000	Housing Cover
46	1192645	21A-5000SG	Housing Cover Screw (4 req)	46	1192645	21A-5000SG	Housing Cover Screw (4 req)
47	1529381	47-BTL1113000	Spool Assembly	47	1529381	47-BTL1113000	Spool Assembly
47D	1489217	47D-SSVT3500	Line Clip	47D	1489217	47D-SSVT3500	Line Clip
47F	1489218	47F-SSVT3500	Line Clip Spring	47F	1489218	47F-SSVT3500	Line Clip Spring
47H	1489219	47H-SSVT3500	Line Clip Spring Screw	47H	1489219	47H-SSVT3500	Line Clip Spring Screw
48	1211604	48-3000SG	Click Tongue	48	1211604	48-3000SG	Click Tongue
48A	1214226	48A-3000SG	Click Tongue Washer	48A	1214226	48A-3000SG	Click Tongue Washer
48B	1489220	48B-SSVT3500	Spool Click Screw	48B	1489220	48B-SSVT3500	Spool Click Screw
49	1211605	49-3000SG	Click Tongue Spring	49	1211605	49-3000SG	Click Tongue Spring
51	1308078	51-CFT3000	Drag Retaining Ring	51	1308078	51-CFT3000	Drag Retaining Ring
52	1529382	52-BTL1113000	Drag Knob Assembly	52	1529382	52-BTL1113000	Drag Knob Assembly
56	1308080	56-CFT3000	Drag Washer (3 req)	56	1308080	56-CFT3000	Drag Washer (3 req)
57	1192043	57-3000SG	Keyed Washer (3 req)	57	1192043	57-3000SG	Keyed Washer (3 req)
60	1529383	60-BTL1113000	Thrust Washer	60	1529383	60-BTL1113000	Thrust Washer
60	1529383	60-BTL1113000	Thrust Washer	60	1529383	60-BTL1113000	Thrust Washer
95B	1308081	95B-CFT3000	Rotor Locking Plate	95B	1308081	95B-CFT3000	Rotor Locking Plate
98C	1308082	98C-CFT3000	Clutch/Sleeve Assembly	98C	1308082	98C-CFT3000	Clutch/Sleeve Assembly
98W	1204004	98W-3000PUR	Clutch Washer (2 req)	98W	1204004	98W-3000PUR	Clutch Washer (2 req)
132	1529384	132-BTL1113000	Roller Washer	132	1529384	132-BTL1113000	Roller Washer
132A	1489225	132A-SSVT3500	Line Roller Bushing	132A	1489225	132A-SSVT3500	Line Roller Bushing
226	1529385	226-BTL1113000	Rear Cover	226	1529385	226-BTL1113000	Rear Cover
226A	1529386	226A-BTL1113000	Rear Cover Screw	226A	1529386	226A-BTL1113000	Rear Cover Screw
231	1485217	231-PUR1113000	Crosswind Gear	231	1485217	231-PUR1113000	Crosswind Gear
231B	1489230	231B-SSVT3500	Crosswind Gear Screw	231B	1489230	231B-SSVT3500	Crosswind Gear Screw
233	1529387	233-BTL1113000	Bearing Cover Assy	233	1529387	233-BTL1113000	Bearing Cover Assy