

TORQUE

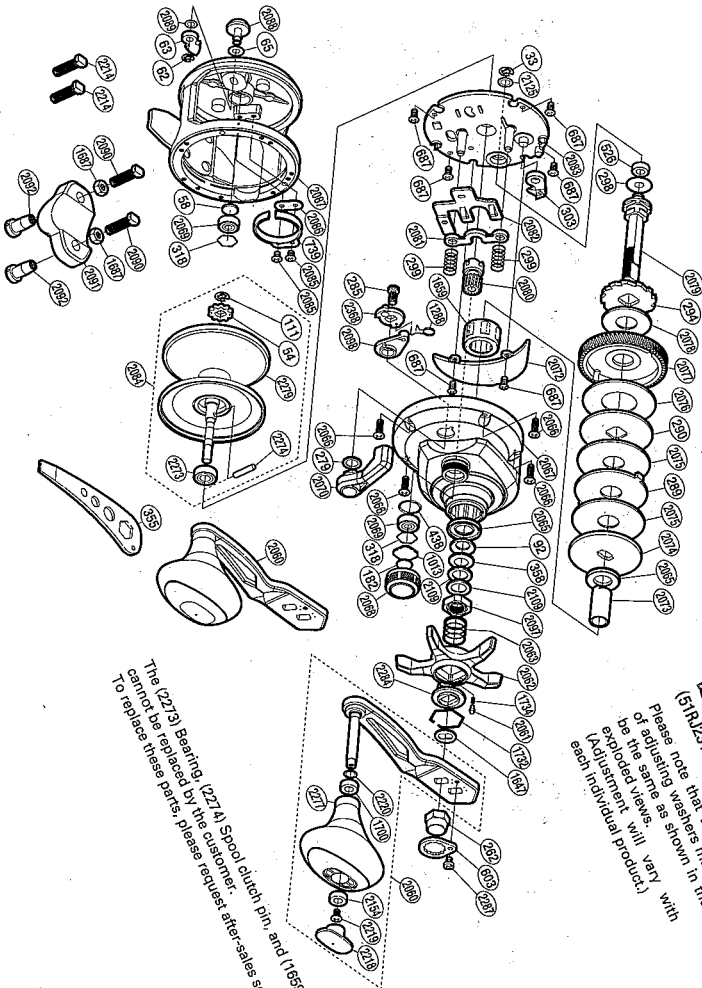

Please note that the number of adjusting washers may not be the same as shown in the exploded views.
Adjustment will vary with each individual product.



The (2273) Bearing, (2274) Spool clutch pin, and (1859) Roller clutch cannot be replaced by the customer.
To replace these parts, please request after-sales service.

Part No.	Description	Part No.	Description	Part No.	Description
TG10033	Drive Shaft Retainer	TG11639	Roller Clutch Bearing	TG12086	Click Spring Washer
TG10054	Click Gear	TG11700	Handle Knob Bushing B	TG12087	Click Button
TG10055	E Lock	TG11722	Click Spring	TG12088	Washer
TG10063	Click Pawl	TG11724	Handle Plate Retainer	TG12089	Star Drag Nut
TG10065	Spacer A	TG12061	Click Pin (B)	TG12097	Eccentric Cam Bushing
TG10092	Coned Disc Spring (BR)	TG12062	Star Drag Spring	TG12109	Star Drag Washer
TG10111	E Lock	TG12063	Star Drag Water Proof	TG12125	Handle Knob Seal
TG10182	Cast Control Spacer	TG12065	Roller Clutch Assembly	TG12200	Washer
TG10262	Handle Nut	TG12066	Screw	TG12273	Ball Bearing
TG10273	Smoother	TG12067	Right Side Plate Cap	TG12274	Spool
TG10285	Screw	TG12068	Cast Control Cap	TG12275	Spool
TG10289	Eared Washer (E)	TG12069	Ball Bearing	TG12284	Screw
TG10290	Key Washer (C)	TG12070	Clutch Lever	TG12287	Star Drag Click Plate
TG10291	Anti-Reverse Ratchet	TG12072	Roller Clutch Inner Tube	TG12288	Click Cam Assembly
TG10292	Washer	TG12073	Key Washer	TG12090	Rod Clamp Bolt
TG10298	Yoke Spring	TG12074	Drag Washer B	TG12091	Rod Clamp Nut B
TG10299	Anti-Reverse Pawl	TG12075	Drag Washer A	TG12092	Rod Clamp Nut A
TG10303	Bearing Retainer	TG12076	Drive Washer	TG12214	Rod Clamp Bolt
TG10305	Coned Disc Spring (B)	TG12077	Drive Washer	TG10355	Wrench
TG10306	O Ring	TG12078	Drive Gear		
TG10308	Drive Shaft Bushing	TG12080	Pinion Gear		
TG10326	Handle Nut Plate	TG12081	Yoke		
TG10329	Drive Shaft Spacer	TG12082	Yoke Side Plate Set		
TG10681	Screw	TG12083	Right Side Plate Set		
TG10708	Click Spring	TG12085	Spool Assembly		
TG11013	Spool Spring	TG12086	Screw		
TG11288	Click Spring				
TG11647	Drive Shaft Shield				